

Tenda



A33

AX3000 Wi-Fi 6 Range Extender



A33

AX3000 Wi-Fi 6 Range Extender

Product Description

A33 is a dual-band AX3000 Wi-Fi 6 range extender designed for large houses, with 5GHz wireless speed up to 2402Mbps and 2.4 GHz wireless speed up to 574 Mbps. The performance of A33 is more outstanding compared with the AX1800 Wi-Fi 6 extender. A33 is equipped with 2*5dBi high-gain antennas, which can significantly improve signal reception and coverage. The function of the automatic pop-up window setting page with the external smart signal light greatly enhances the user's setting experience. A33 provides an external gigabit ethernet port wired connection for set-top boxes, PC, video game consoles and smart TVs, etc., making the connection more flexible.

Selling Points

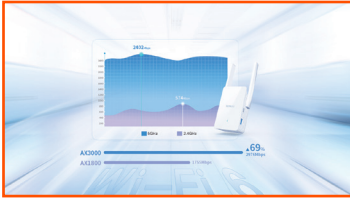

Ultra-speed with AX3000 Wi-Fi 6

A33 supports 160MHz bandwidth for dramatically faster wireless connections. With a total networking speed of about 2976Mbps.- 2.4 GHz: 574 Mbps; 5GHz: 2402 Mbps



Extending network without Dead Zone

2 * 5dbi external dual-band antennas to expand wireless network, efficiently delivering superspeed and seamless connectivity to every corner of your home.



More Devices, Low latency

Improving the network utilization rate with MU-MIMO and supporting simultaneous communication with 25+ wireless terminals.

*Above data comes from tests conducted in the Tenda laboratory. The data vary in the different testing environments and network conditions.



Flexible Backhaul Connection

A33 supports Wi-Fi extending mode and establishes Ethernet backhaul with on-wall Ethernet sockets to create a wired connection between A33 and routers.

Selling Points



Bridging with Smart LED Indicator

Find the best point for the Wi-Fi bridge then improve the quality of signal extension with smart LED indicators.

- Blue light: Good signal connection range; Yellow light: Normal signal connection range; Red light: Unavailable signal connection range

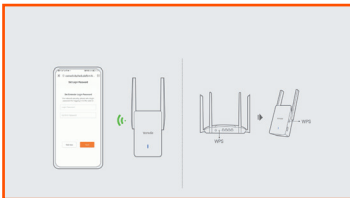

Easy Setup in One Step

Method 1: The setting page pops up automatically once your device is connected to A33, establishing the connection easier.

Method 2: The connection can be established with the WPS button. The bridge pairing has been successful once the signal indicator turns solid blue or yellow.

Specification

Hardware features	
Interface	1*10/100/1000Mbps RJ45
Antenna Type	2 * 5dBi dual-band antennas
Button	1 * WPS Button;1 * Reset Button
LED indicator	1 * System LED
Power Supply	12V1A, built-in
Power Consumption	11W (max power consumption)
Dimensions	123*72*47.5mm(L x W x H)
Wireless features	
Wireless Standards	IEEE802.11b,IEEE 802.11g, IEEE 802.11n, IEEE 802.11a, IEEE 802.11ac, IEEE802.11ax
Frequency	5GHz (11ax) 2.4GHz
RSSI	2.4 GHz 11b-1M:-97dBm 11g-54M:-76dBm 11n-20M-MCS7:-74dBm 11n-40M-MCS7:-72dBm 5 GHz: 11a-6M:-95dBm 11n-20M-MCS7:-74dBm 11n-40M-MCS7:-72dBm 11ac-80M-MCS9:-63dBm
Data Rate	5GHz: Up to 2402Mbps 2.4GHz: Up to 574Mbps
Transmit Power	<20dBm (EIRP)
Wireless Modes	Repeater Mode , Access Point Mode
Wireless Security	Default encryption mode: Mix WPA-PSK/WPA2-PSK/WPA3; WPA algorithm: TKIP

Others

Certification	CE,FCC,RoHS
Plug Type	US、EU、UK、AU、BR
Package Contents	1 * AX3000 Wi-Fi 6 Range Extender 1 * Quick Installation Guide
System Tool	Online Upgrade, LED Indicator Control, DST, Factory Settings, Login Password and Reboot
Environment	Operating Temperature: 0°C ~ 40°C(32°F ~ 104°F) Storage Temperature: -40°F ~ 158°F (-40°C ~ 70°C) Operating Humidity: 10% ~ 90% RH non-condensing Storage Humidity: 5% ~ 90%RH non-condensing
Related Products	AX3、RX3、RX9 Pro

SHENZHEN TENDA TECHNOLOGY CO.,LTD.

Tenda Technology Bldg.Int'l E-City,
#1001 Zhong Shan Yuan Rd.,Nanshan District,Shenzhen China.

E-mail:support@tenda.com.cn

Tel:+86-755-2765 7098

Fax:+86-755-2765 7178

PC:518055

